

MARCH 21ST 10.00 AM

SCALE: 1:1250

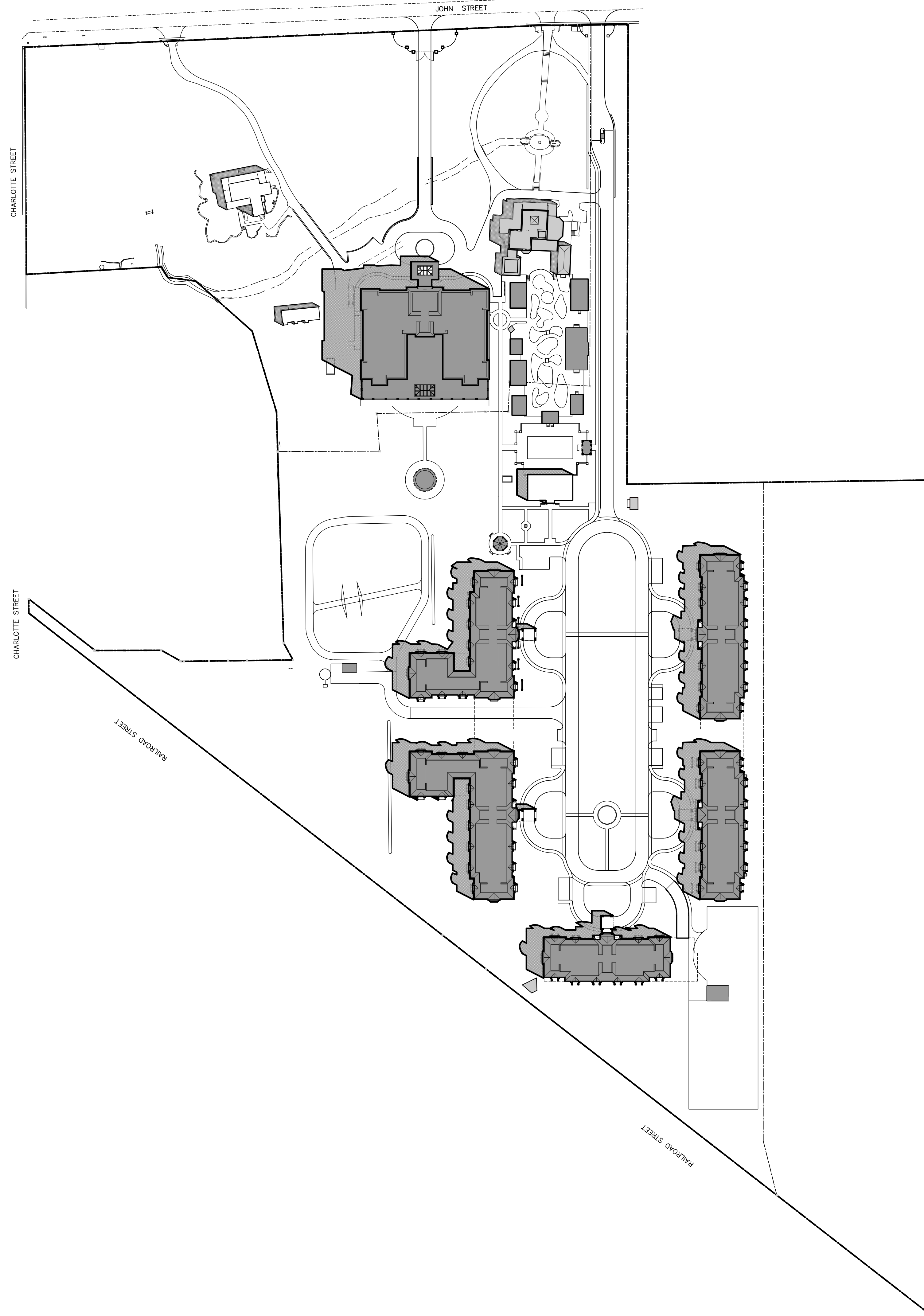
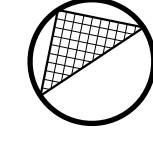

MARCH 21ST 12.00 AM

SCALE: 1:1250

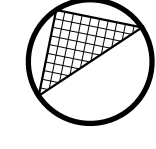

DATE: Nov. 18/ 22
 SCALE: 1:750
 DRAWN BY: MW/OD
 CHECK BY: P.JL

**RITZ-CARLTON HOTEL,
 SPA & RESIDENCES**
 144, 176 & 200 John St., 856 Charlotte St.
 Niagara-on-the-Lake, Ontario

DATE	#	REVISIONS	DATE	REVISIONS
Nov. 10/ 20		FOR COORDINATION		
Nov. 13/ 20		FOR ZONING		

SHADOW STUDY
MARCH 21st
 144, 176 & 200 John St.,
 856 Charlotte St



Peter J. Lesdow
architect
 ARCHITECTURE: 144, 176 & 200 JOHN ST., NIAGARA-FALLS, ONTARIO, L8E 0E3
 905.335.1111 | WWW.PJLESADOW.COM

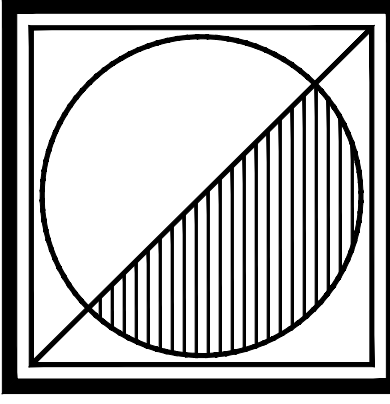

25 - 01

SH-1

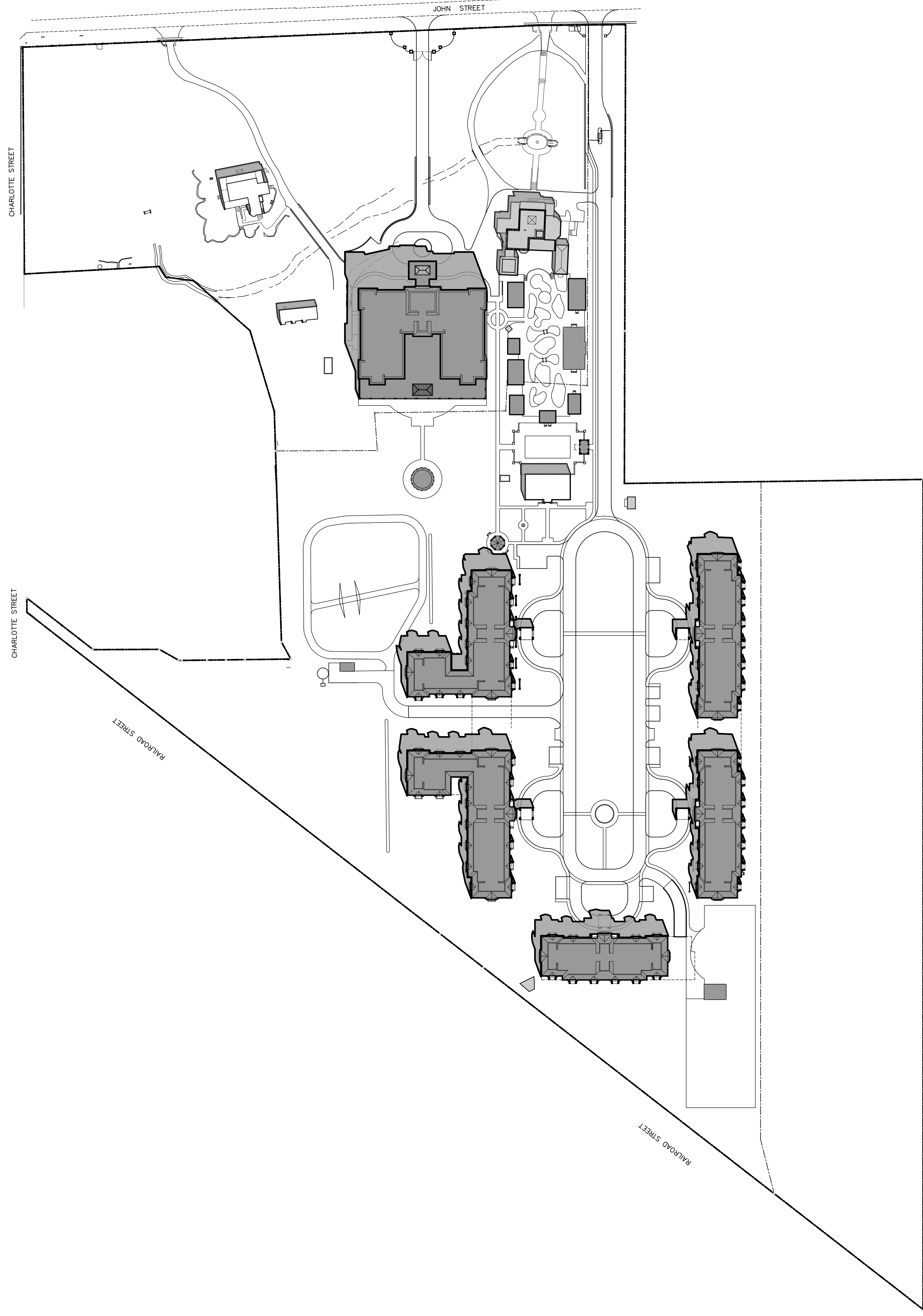

MARCH 21ST 02.00 PM

SCALE: 1:1250

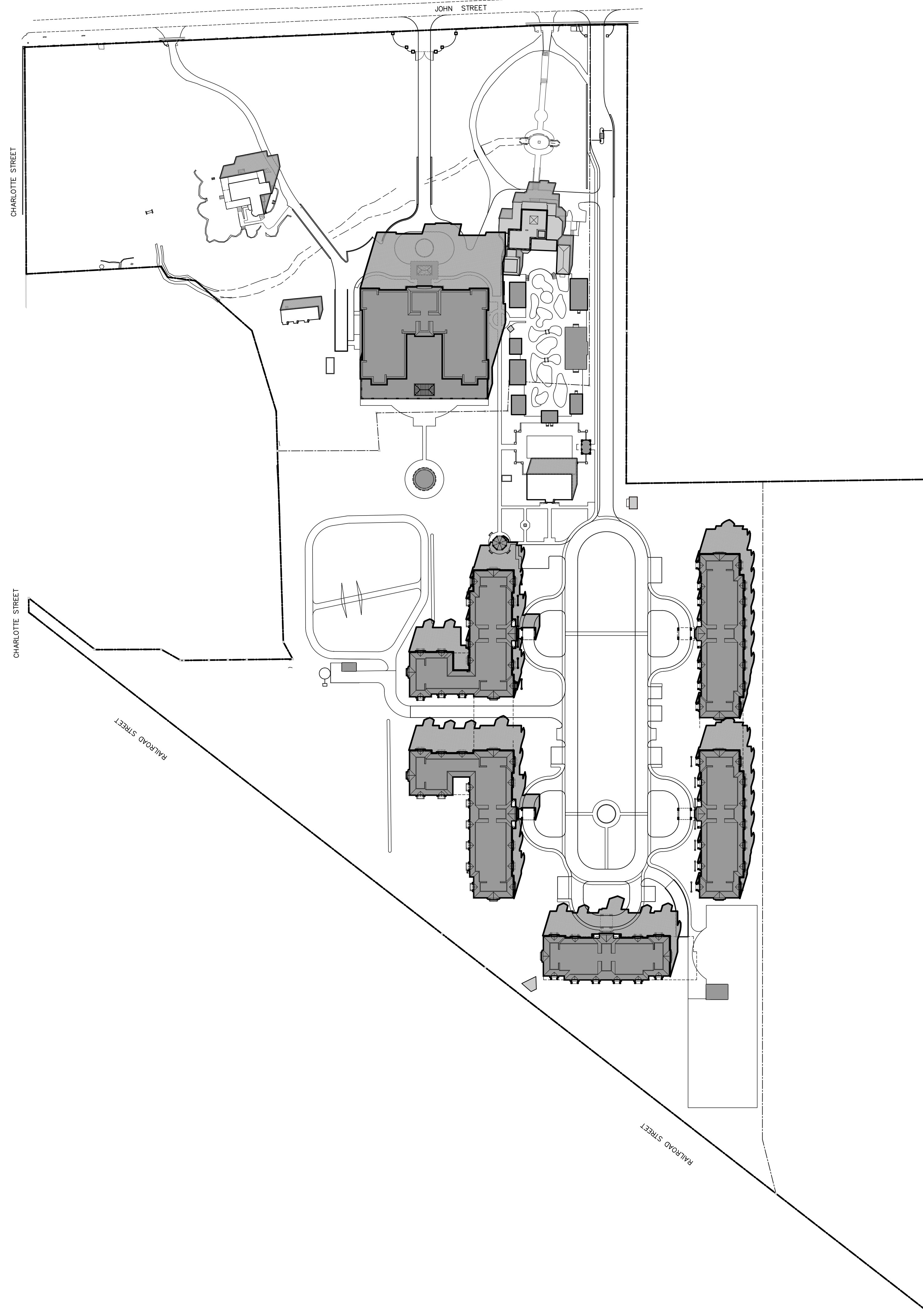
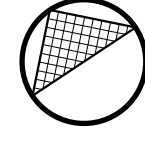

MARCH 21ST 04.00 PM

SCALE: 1:1250

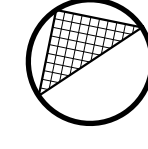

DATE: Nov. 18/ 22
 SCALE: 1:750
 DRAWN BY: MW/OD
 CHECK BY: P.JL

**RITZ-CARLTON HOTEL,
 SPA & RESIDENCES**
 144, 176 & 200 John St., 856 Charlotte St.
 Niagara-on-the-Lake, Ontario

DATE	#	REVISIONS	DATE	REVISIONS
Nov. 10/ 20		FOR COORDINATION		
Nov. 13/ 20		FOR ZONING		

SHADOW STUDY
MARCH 21st
 144, 176 & 200 John St.,
 856 Charlotte St



Peter J. Lesdow
 architect
 ARCHITECTURE: 144, 176 & 200 JOHN ST., NIAGARA-FALLS, ONTARIO, L8E 0E3
 905.335.1111 | WWW.PJLESADOW.COM

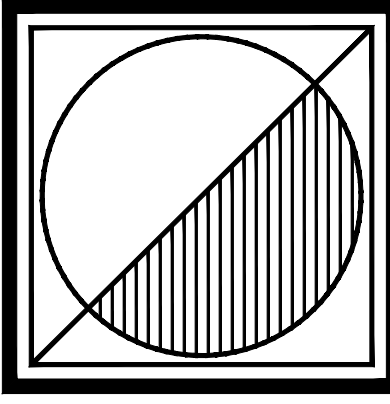

SH-2

25 - 01

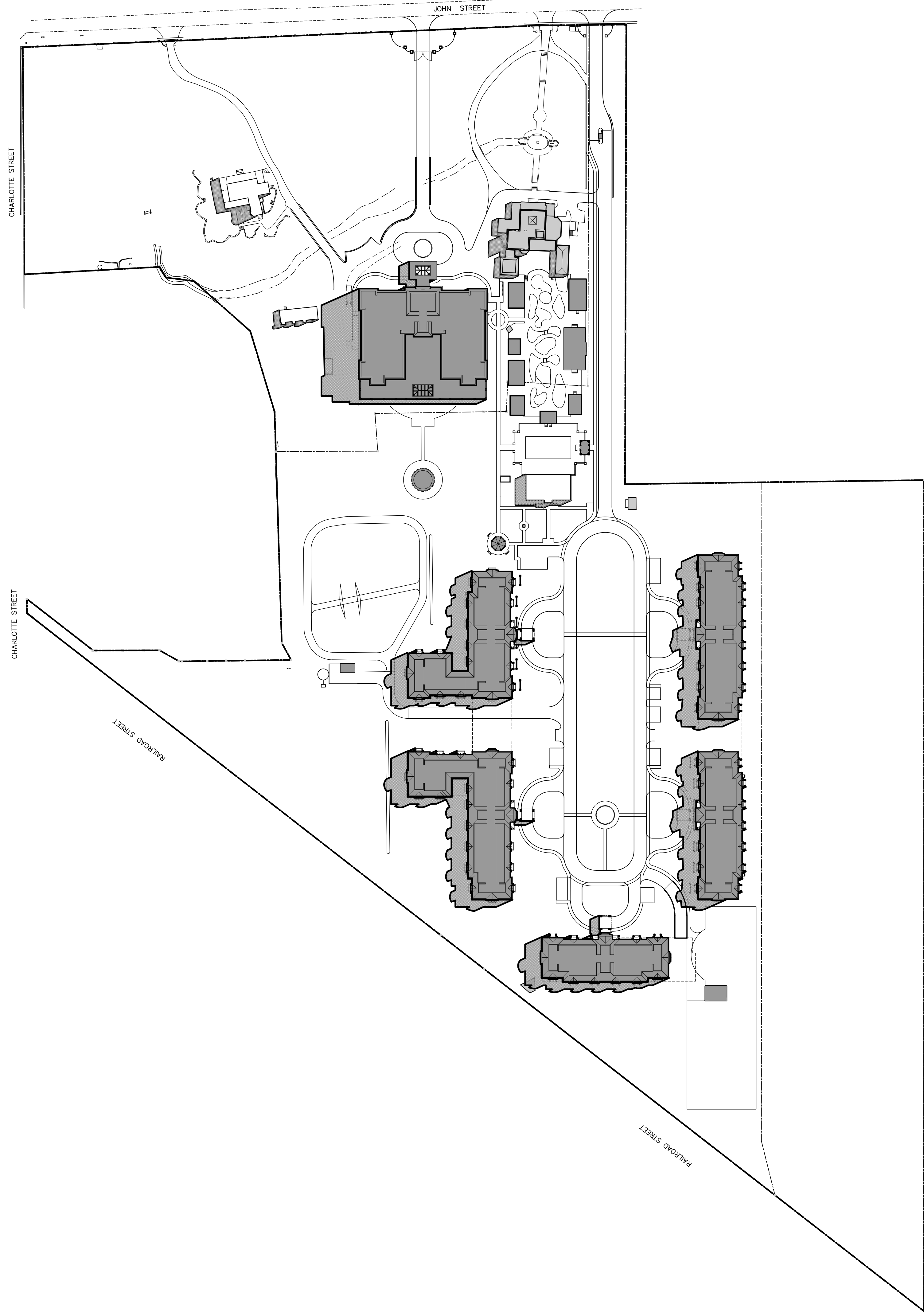

JUNE 21ST 10.00 AM

SCALE: 1:1250

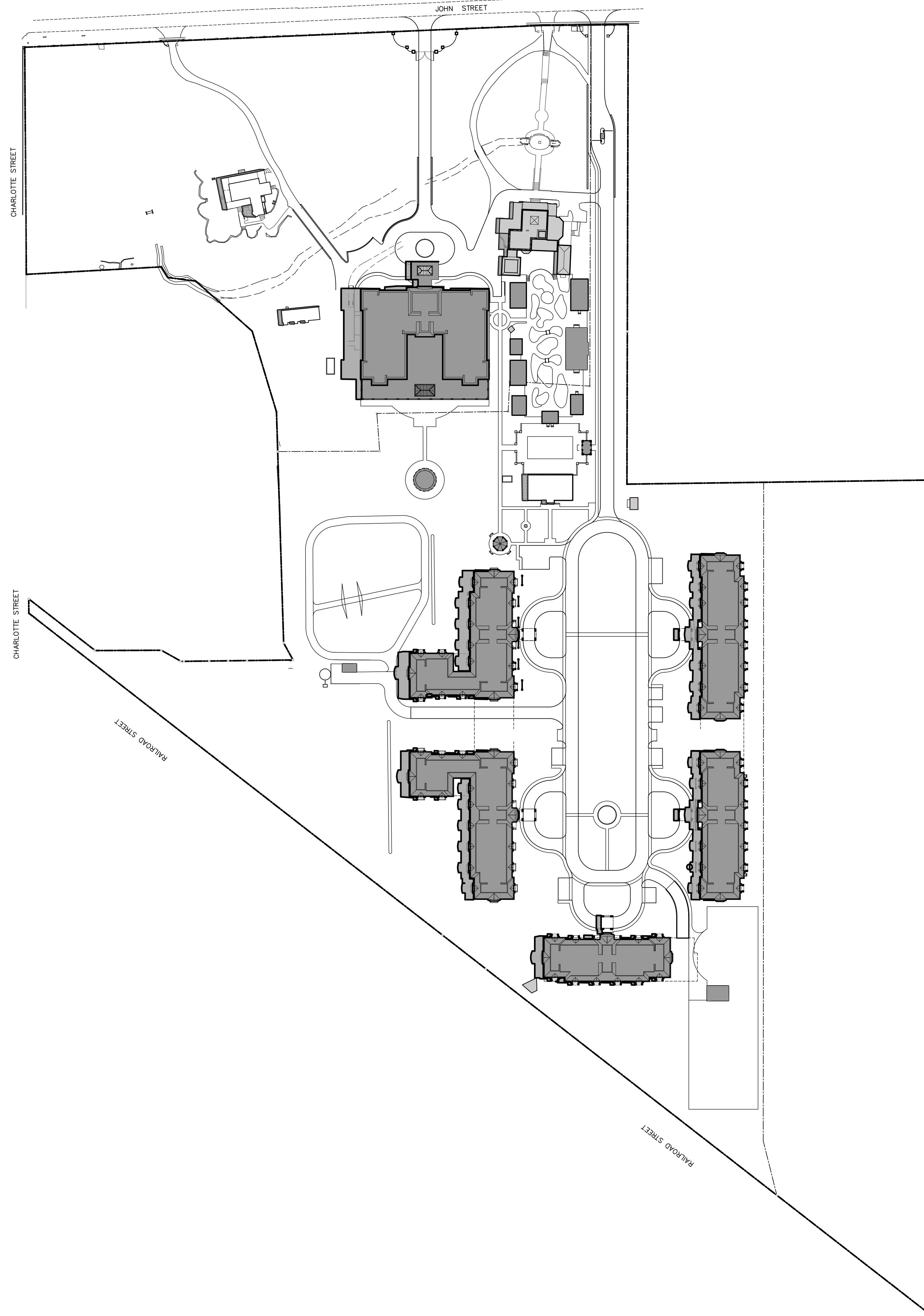
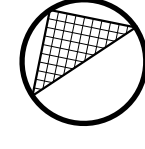

JUNE 21ST 12.00 AM

SCALE: 1:1250

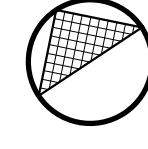

DATE: Nov. 18/ 22
 SCALE: 1:750
 DRAWN BY: MW/OD
 CHECK BY: P.JL

**RITZ-CARLTON HOTEL,
 SPA & RESIDENCES**
 144, 176 & 200 John St., 856 Charlotte St.
 Niagara-on-the-Lake, Ontario

DATE	#	REVISIONS	DATE	REVISIONS
Nov. 10/ 20	1	FOR COORDINATION		
Nov. 13/ 20	2	FOR ZONING		

SHADOW STUDY
JUNE 21st
144, 176 & 200 John St.,
856 Charlotte St



Peter J. Lesdow
architect
 ARCHITECTURE: 144, 176 & 200 JOHN ST., NIAGARA-FALLS, ONTARIO, L8E 6C6
 905.335.1111 | PETER@P.J.L.AO.A.COM

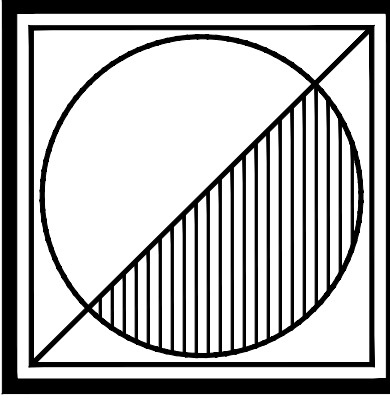

25 - 01

SH-3

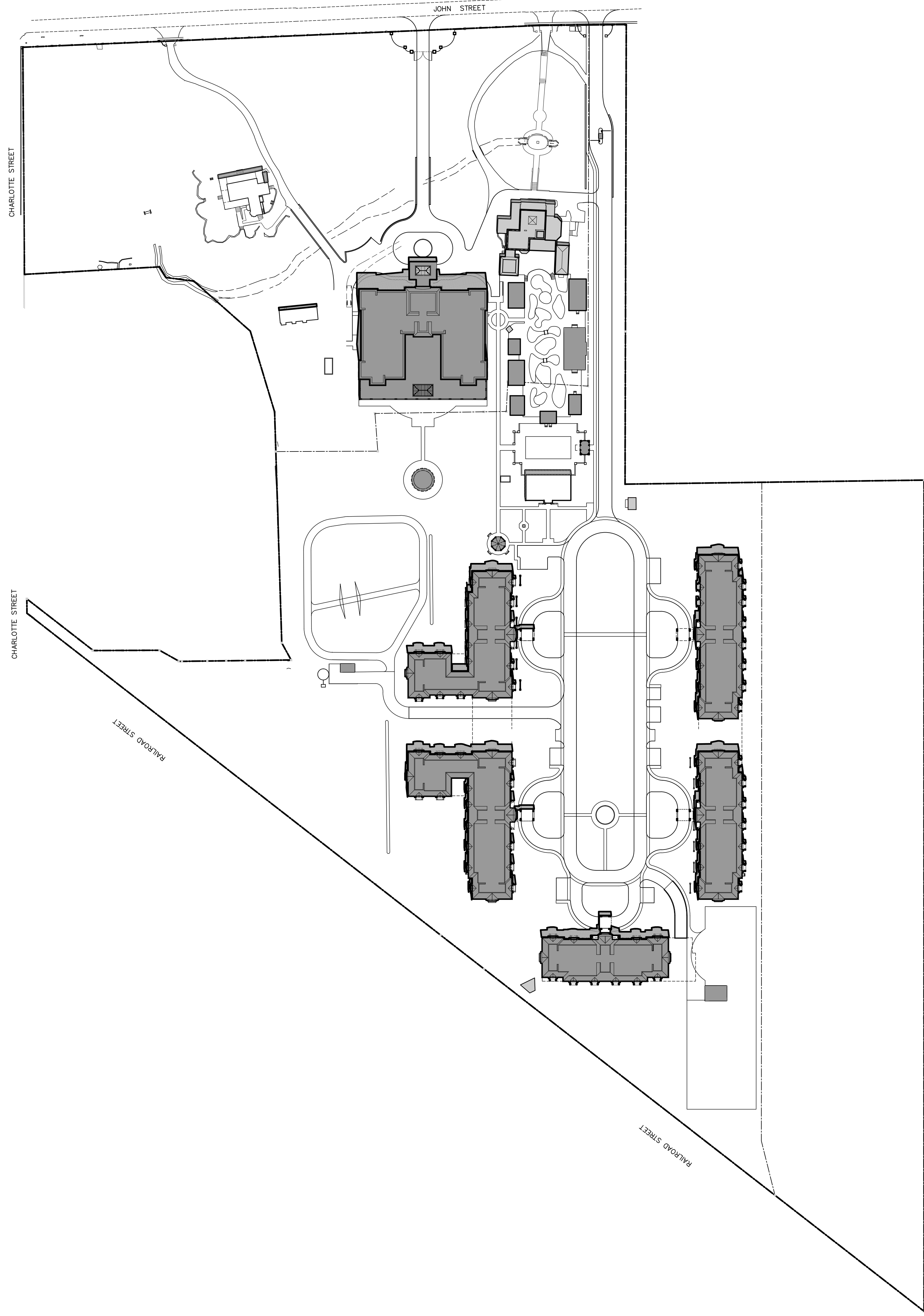

JUNE 21ST 02.00 PM

SCALE: 1:1250

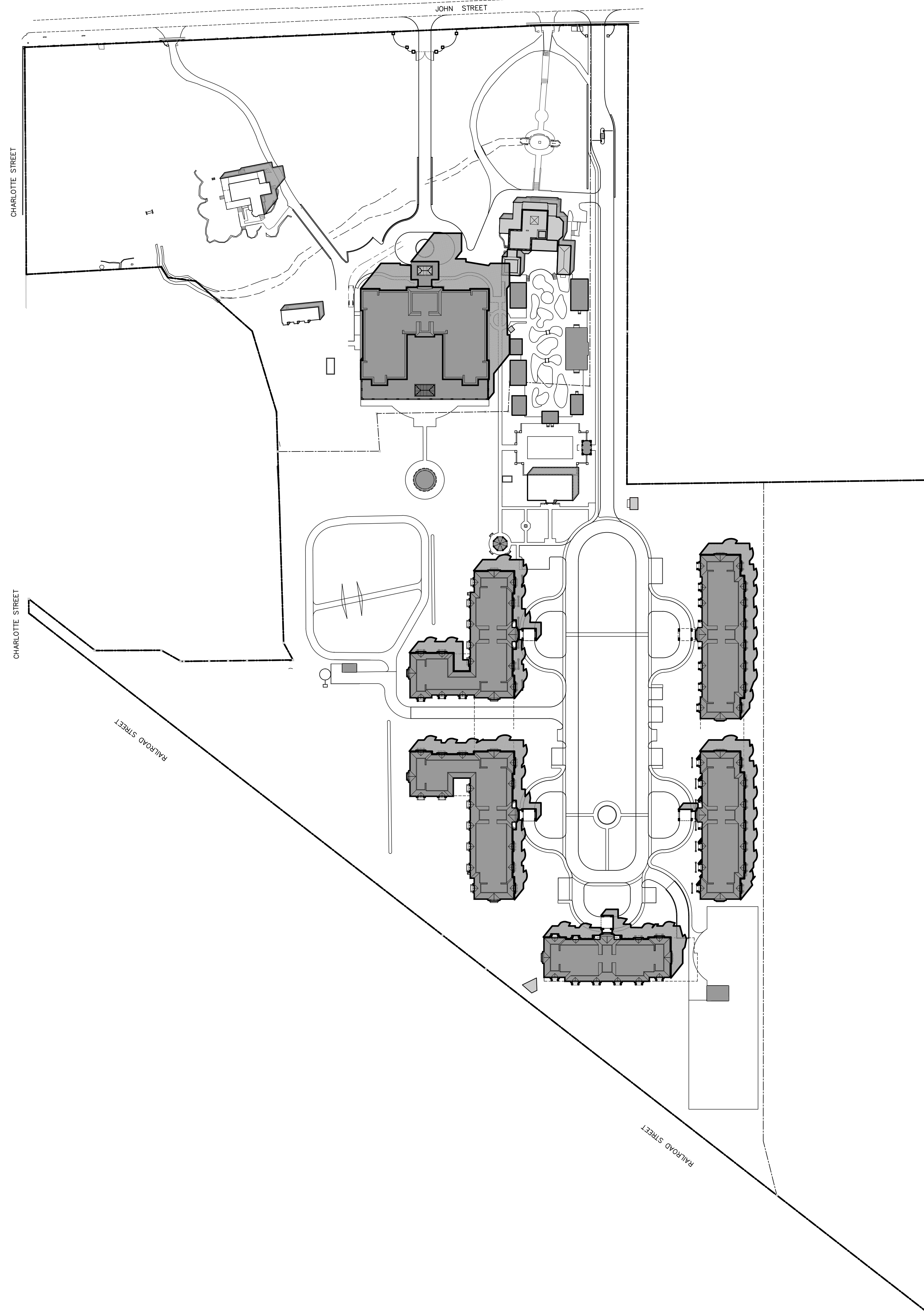
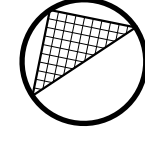

JUNE 21ST 04.00 PM

SCALE: 1:1250

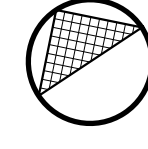

DATE: Nov. 18/ 22
 SCALE: 1:750
 DRAWN BY: MW/OD
 CHECK BY: P.JL

**RITZ-CARLTON HOTEL,
 SPA & RESIDENCES**
 144, 176 & 200 John St., 856 Charlotte St.
 Niagara-on-the-Lake, Ontario

DATE	#	REVISIONS	DATE	REVISIONS
Nov-10/20	1	FOR COORDINATION		
Nov-13/20	2	FOR ZONING		

SHADOW STUDY
JUNE 21st
144, 176 & 200 John St.,
856 Charlotte St



Peter J. Lesdow
architect
 ARCHITECTURE: 144, 176 & 200 JOHN ST., NIAGARA-FALLS, ONTARIO, L8E 0E3
 905.335.1111 | WWW.PETERJLESADOW.COM

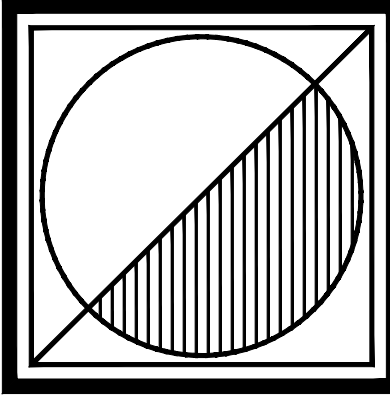

25 - 01

SH-4

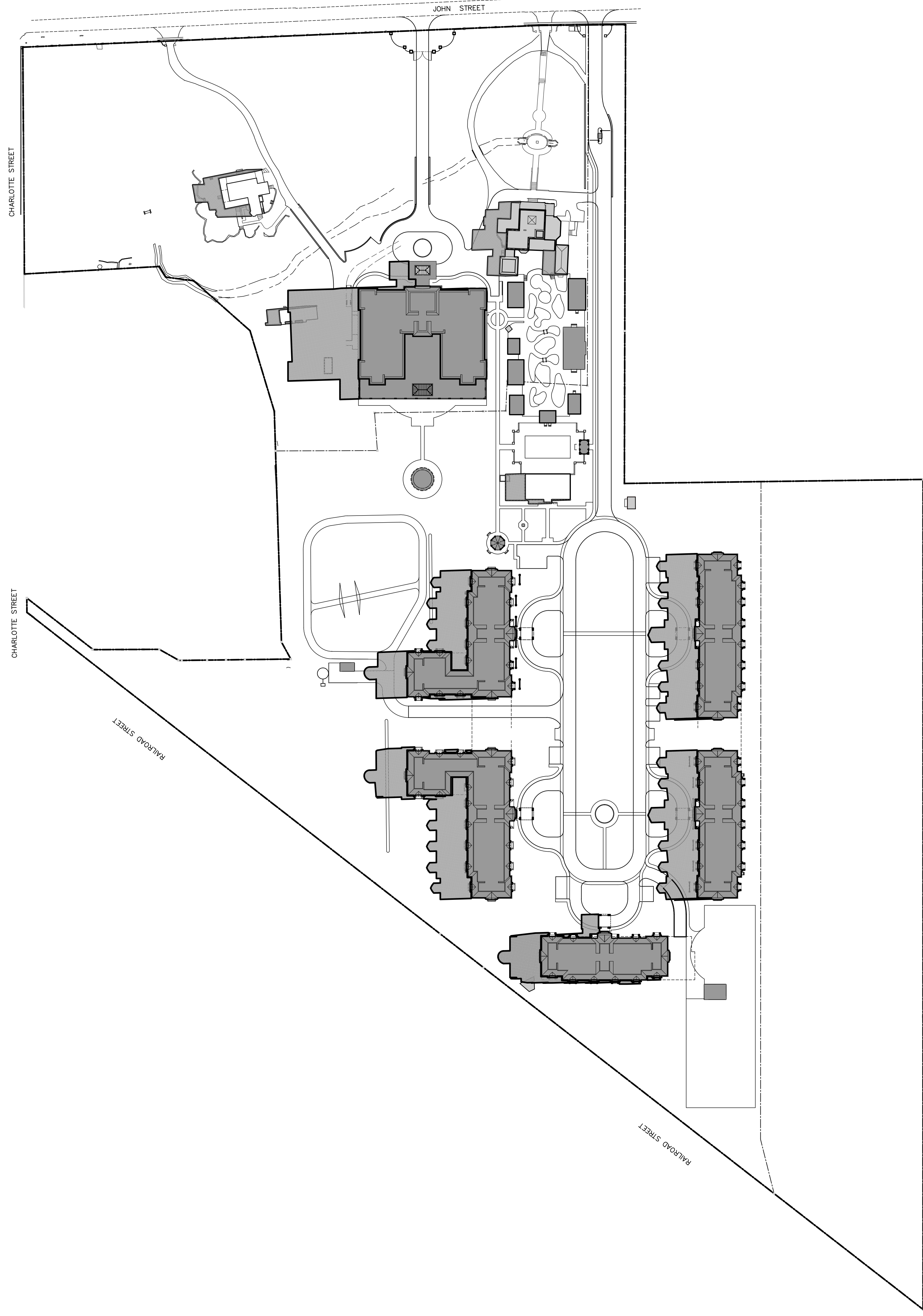

SEPTEMBER 21ST 10.00 AM

SCALE: 1:1250

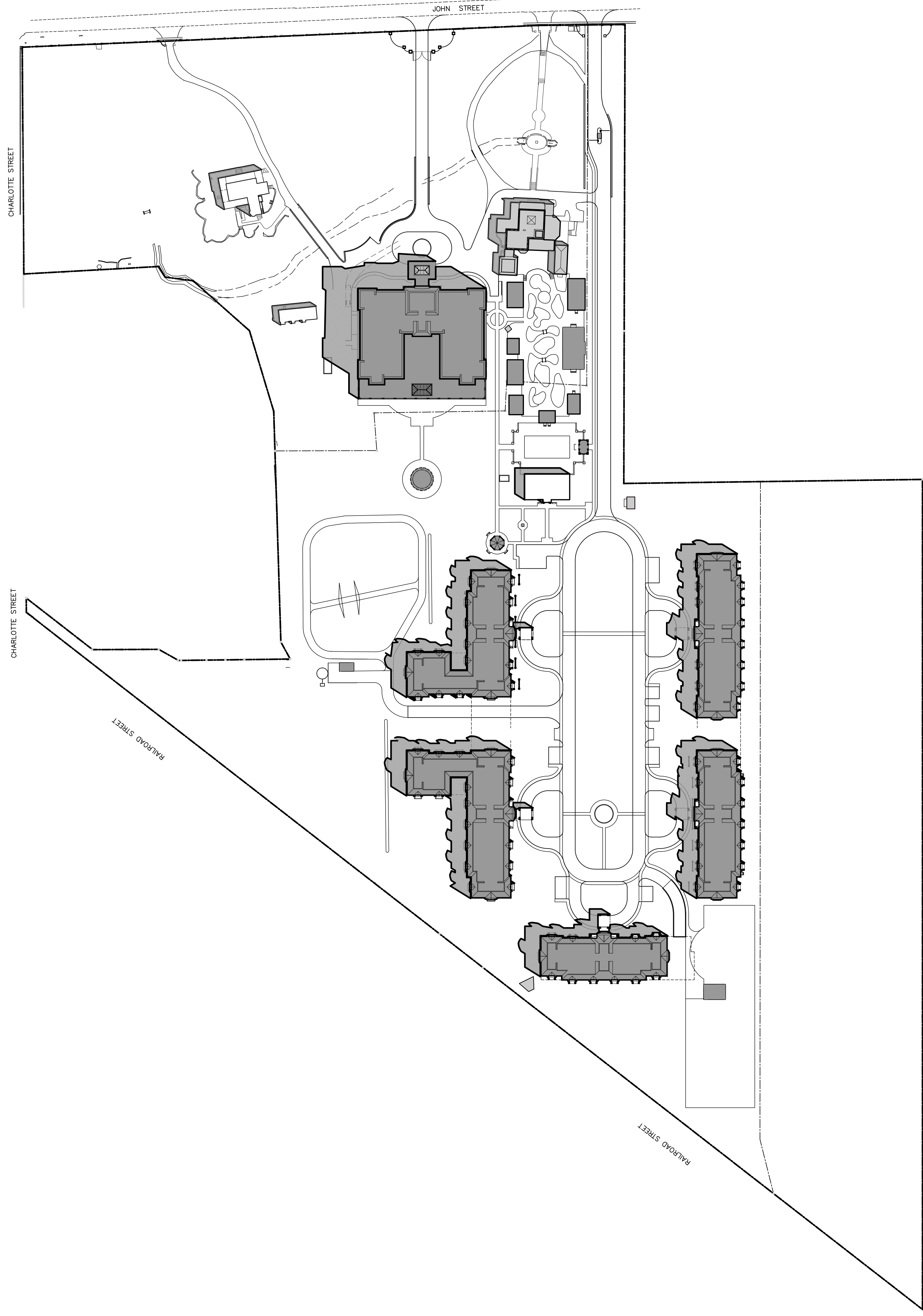
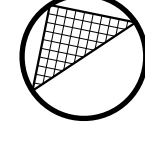

SEPTEMBER 21ST 12.00 AM

SCALE: 1:1250

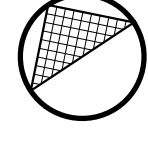

DATE: Nov. 18/ 22
SCALE: 1:750
DRAWN BY: MW/OD
CHECK BY: P.JL

**RITZ-CARLTON HOTEL,
SPA & RESIDENCES**
144, 176 & 200 John St., 856 Charlotte St.
Niagara-on-the-Lake, Ontario

DATE	#	REVISIONS	DATE	REVISIONS
Nov. 10/ 20		FOR COORDINATION		
Nov. 13/ 20		FOR ZONING		

SHADOW STUDY
SEPTEMBER 21st
144, 176 & 200 John St.,
856 Charlotte St



Peter J. Lesdow
architect
ARCHITECTURE: 144, 176 & 200 JOHN ST., NIAGARA-FALLS, ONTARIO, L8E 0E3
ARCHITECT: 856 CHARLOTTE ST., NIAGARA-FALLS, ONTARIO, L8E 0E3

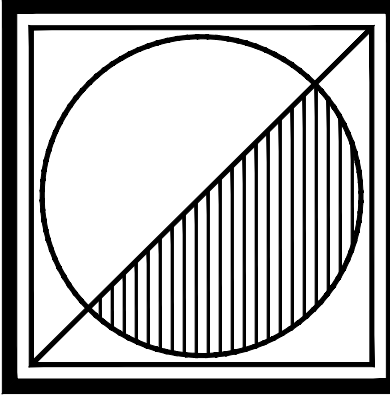

25 - 01

SH-5

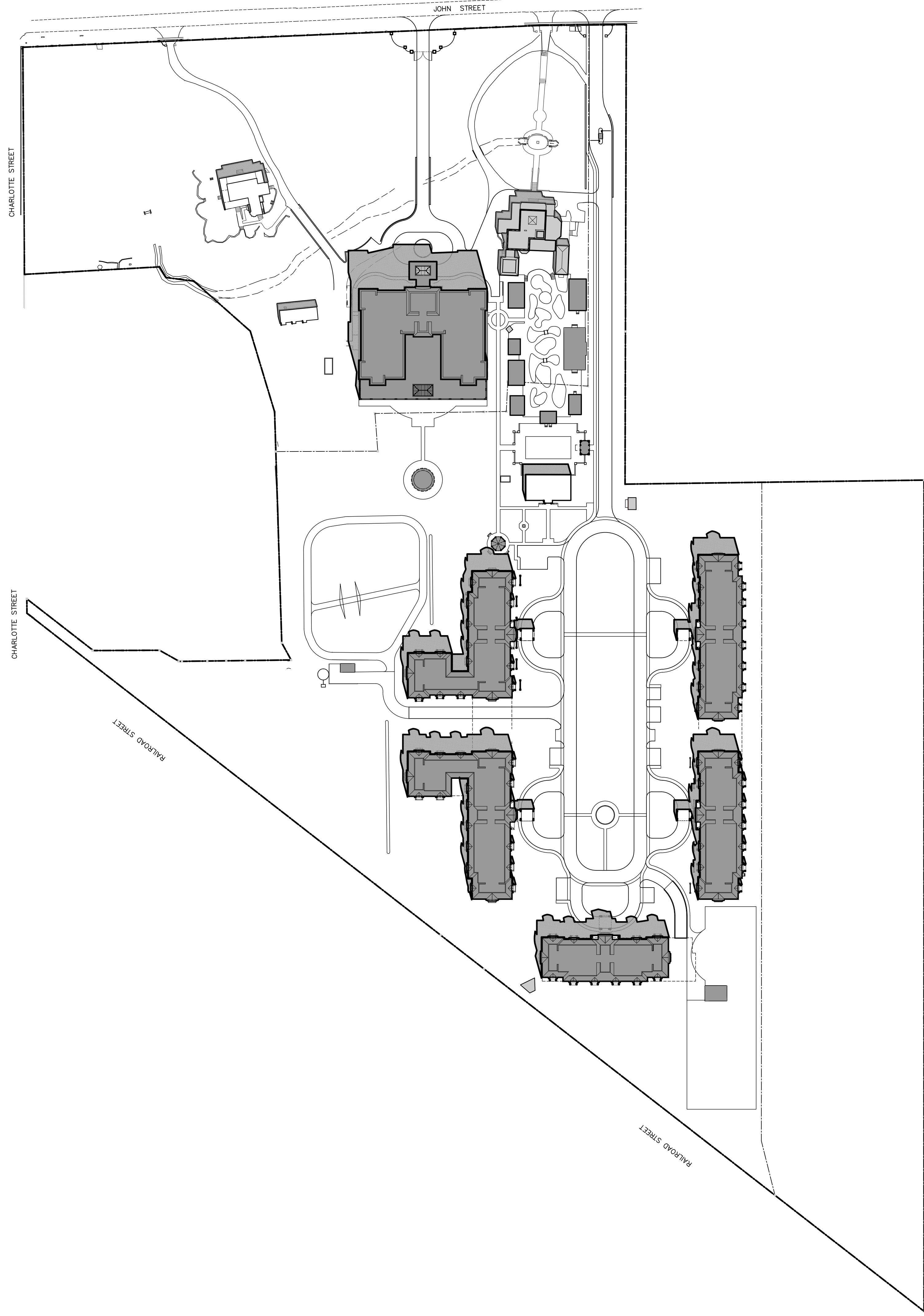

SEPTEMBER 21ST 02.00 PM

SCALE: 1:1250

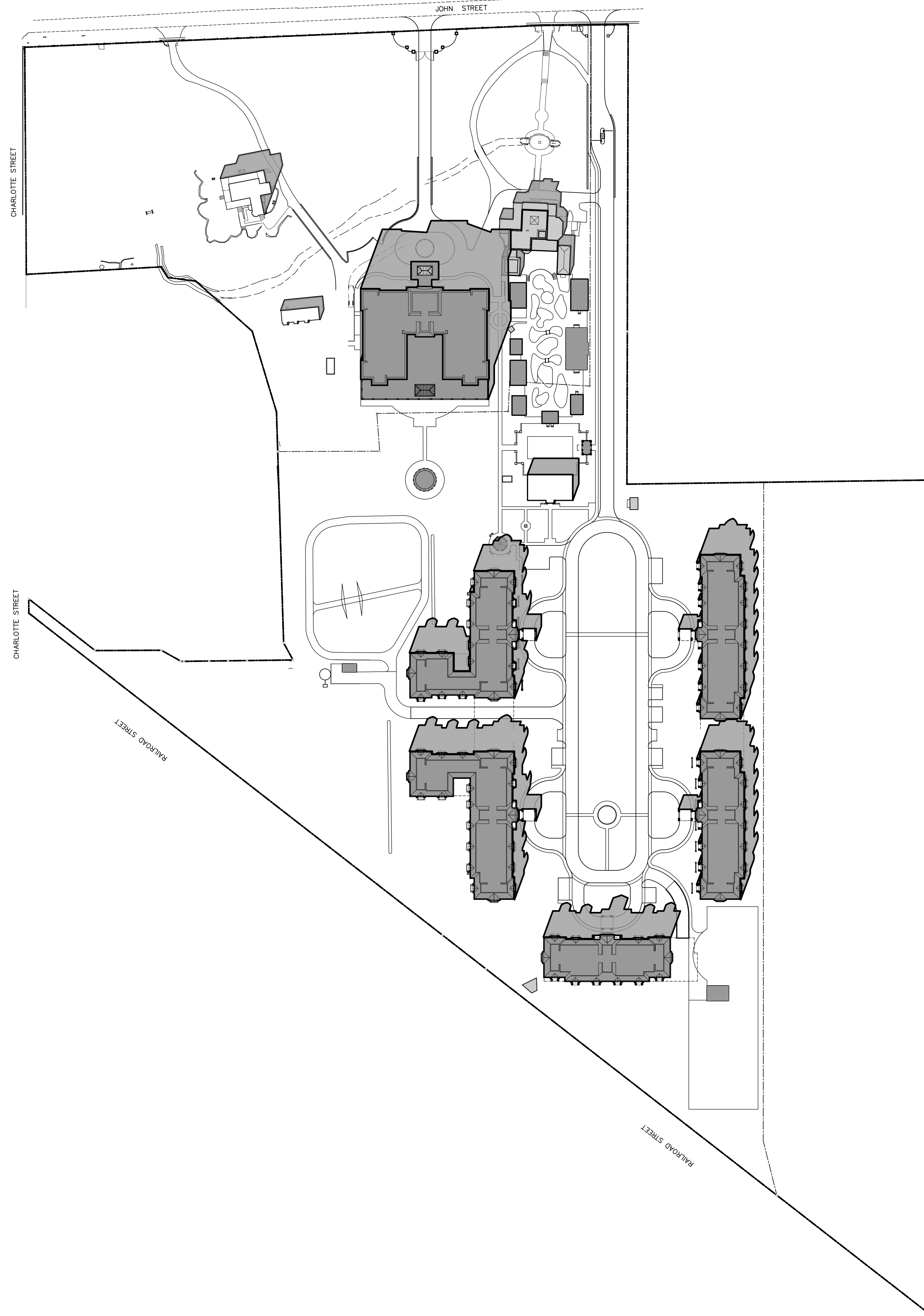
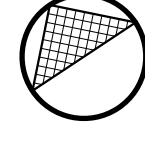

SEPTEMBER 21ST 04.00 PM

SCALE: 1:1250

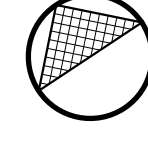

DATE: Nov. 18/22
SCALE: 1:750
DRAWN BY: MW/OD
CHECK BY: P.JL

**RITZ-CARLTON HOTEL,
SPA & RESIDENCES**
144, 176 & 200 John St., 856 Charlotte St.
Niagara-on-the-Lake, Ontario

DATE	#	REVISIONS	DATE	REVISIONS
Nov. 10/22	1	FOR COORDINATION		
Nov. 13/22	2	FOR REZONING		

SHADOW STUDY
SEPTEMBER 21st
144, 176 & 200 John St.,
856 Charlotte St



Peter J. Lesdow
architect
ARCHITECTURE: 144, 176 & 200 JOHN ST., NIAGARA-FALLS, ONTARIO, L8E 0E3
ARCHITECT: 856 CHARLOTTE ST., NIAGARA-FALLS, ONTARIO, L8E 0E3

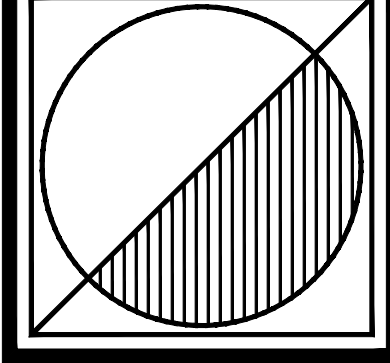

25 - 01

SH-6



DECEMBER 21ST 10.00 AM

SCALE: 1:1250

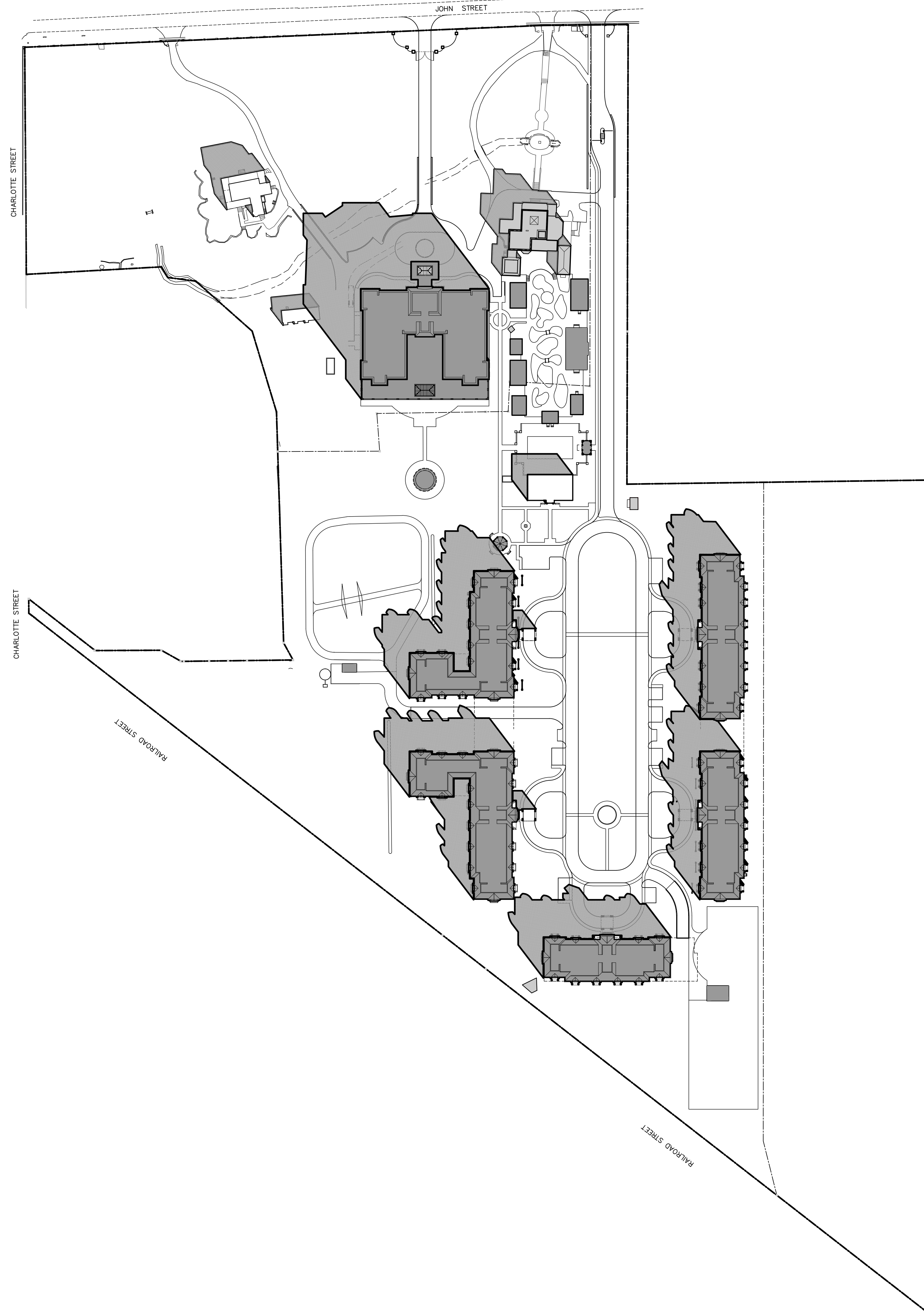
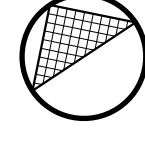

DECEMBER 21ST 12.00 AM

SCALE: 1:1250

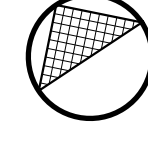

DATE: Nov. 18/ 22
 SCALE: 1:750
 DRAWN BY: MW/OD
 CHECK BY: P.JL

**RITZ-CARLTON HOTEL,
 SPA & RESIDENCES**
 144, 176 & 200 John St., 856 Charlotte St.
 Niagara-on-the-Lake, Ontario

DATE	#	REVISIONS	DATE	REVISIONS
Nov. 10/ 20		FOR COORDINATION		
Nov. 13/ 20		FOR ZONING		

**SHADOW STUDY
 DECEMBER 21st
 144, 176 & 200 John St.,
 856 Charlotte St**



**Peter J. Lesdow
 architect**
ARCHITECTURE: 144, 176 & 200 JOHN ST., NIAGARA-FALLS, ONTARIO, L8E 6C6
 905.335.1111 | PETER@P.LESDOW.COM

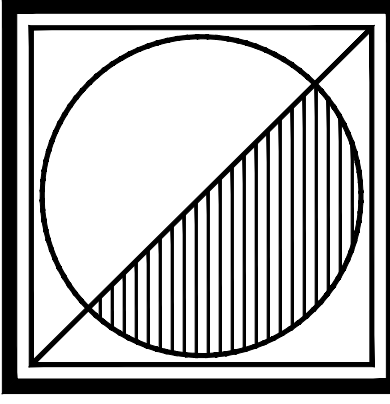

25 - 01

SH-7

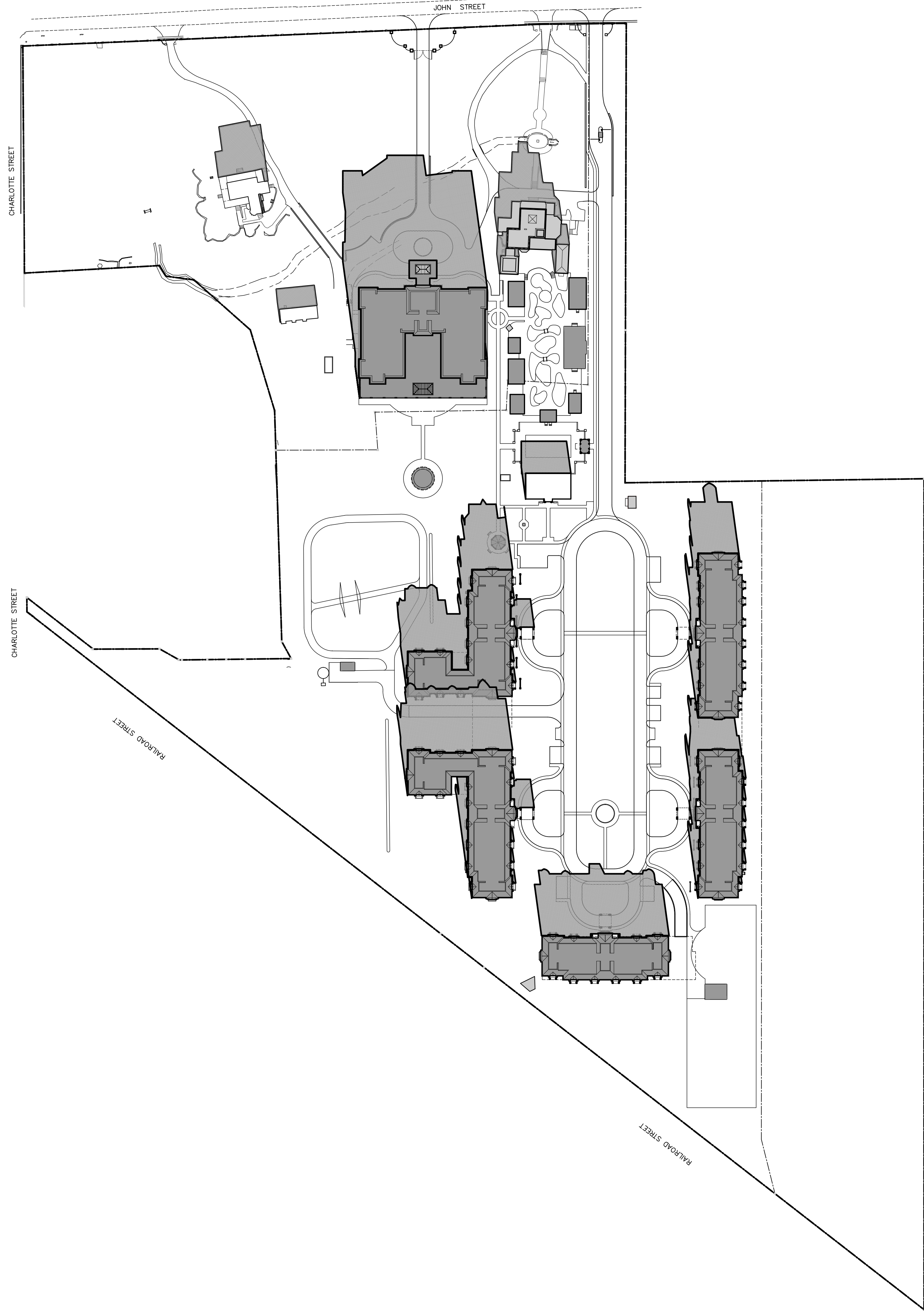

DECEMBER 21ST 02.00 PM

SCALE: 1:1250

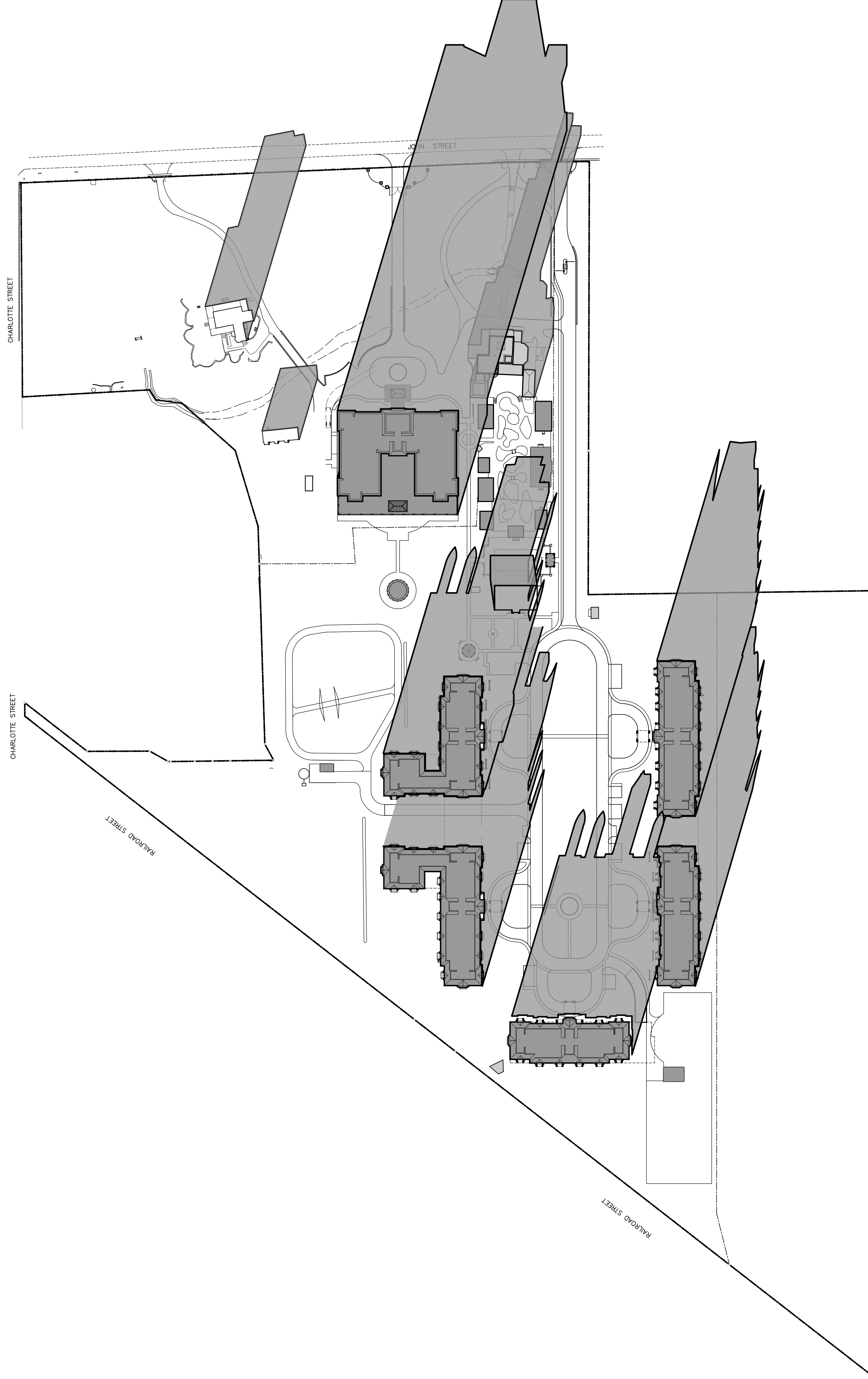
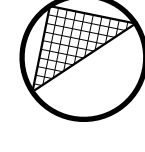

DECEMBER 21ST 04.00 PM

SCALE: 1:1250

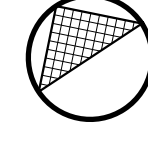

**RITZ-CARLTON HOTEL,
SPA & RESIDENCES**
144, 176 & 200 John St., 856 Charlotte St.
Niagara-on-the-Lake, Ontario

DATE: Nov. 18/ 22
SCALE: 1:750
DRAWN BY: MW/OD
CHECK BY: P.JL

25 - 01

SH-8

DATE	REVISIONS	DATE	REVISIONS
Nov. 10/ 20	FOR COORDINATION		
Nov. 13/ 20	FOR REZONING		

SHADOW STUDY
DECEMBER 21st
144, 176 & 200 John St.,
856 Charlotte St



Peter J. Lesdow
architect
ARCHITECTS INC. 111 Niagara Falls, Ontario, L2E 6C6
PHONE: 905.255.5111 FAX: 905.255.5112

