

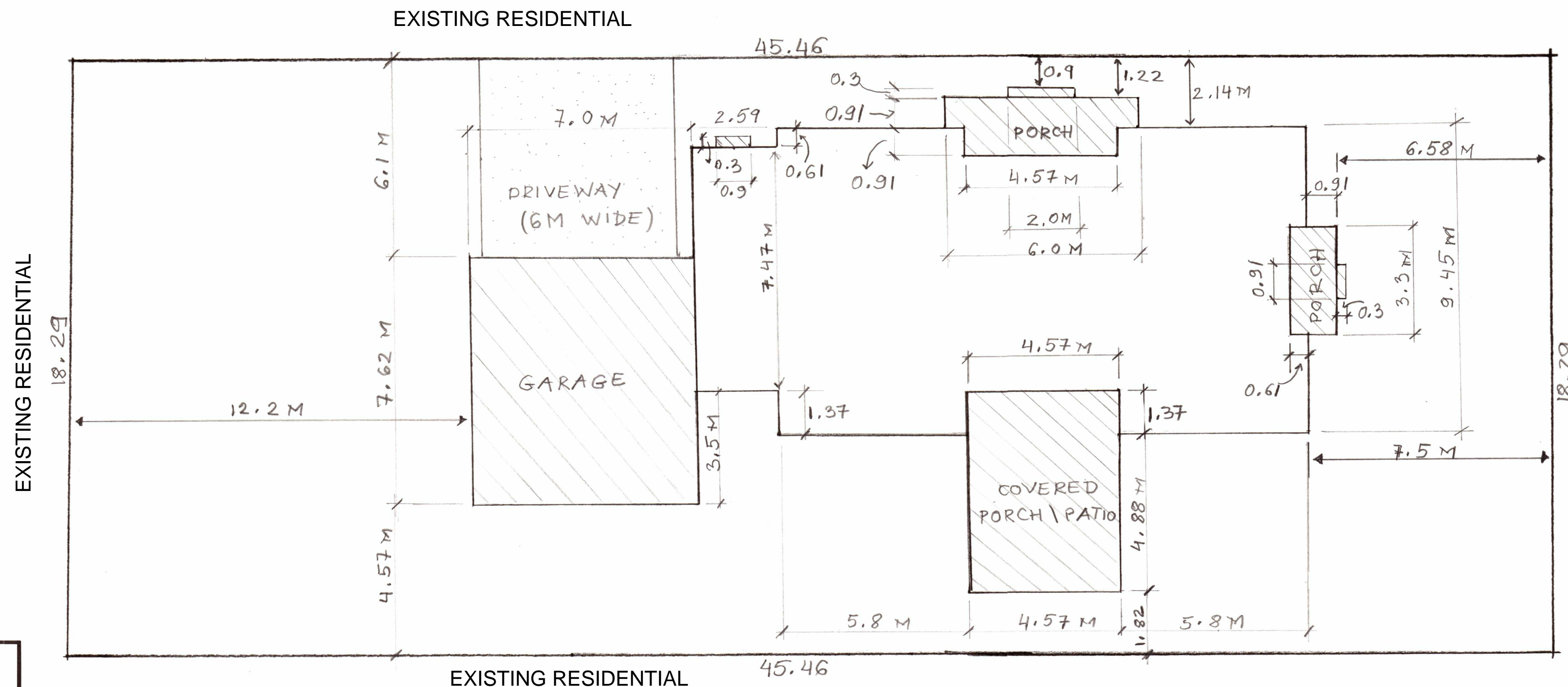

WILLIAM STREET ( MUNICIPAL ROAD – 29.27 WIDE)



PROPOSED PRIVATE  
RESIDENCE

407 VICTORIA STREET  
NOTL, ONTARIO

SITE PLAN (metric)  
SCALE 1:100  
MARCH 19, 2025.

LOT AREA: 831.14 M SQ

COVERAGE AREA:

HOUSE:	159.70 M SQ
GARAGE:	53.34 M SQ
PORCH AND STEPS:	44.30 M SQ
TOTAL:	257.34 M SQ

LOT COVERAGE ( % ) : 30.96 %

VICTORIA STREET ( MUNICIPAL ROAD – 20.12 WIDE)