

WILLIAM STREET (MUNICIPAL ROAD – 29.27 WIDE)

VICTORIA STREET (MUNICIPAL ROAD – 20.12 WIDE)

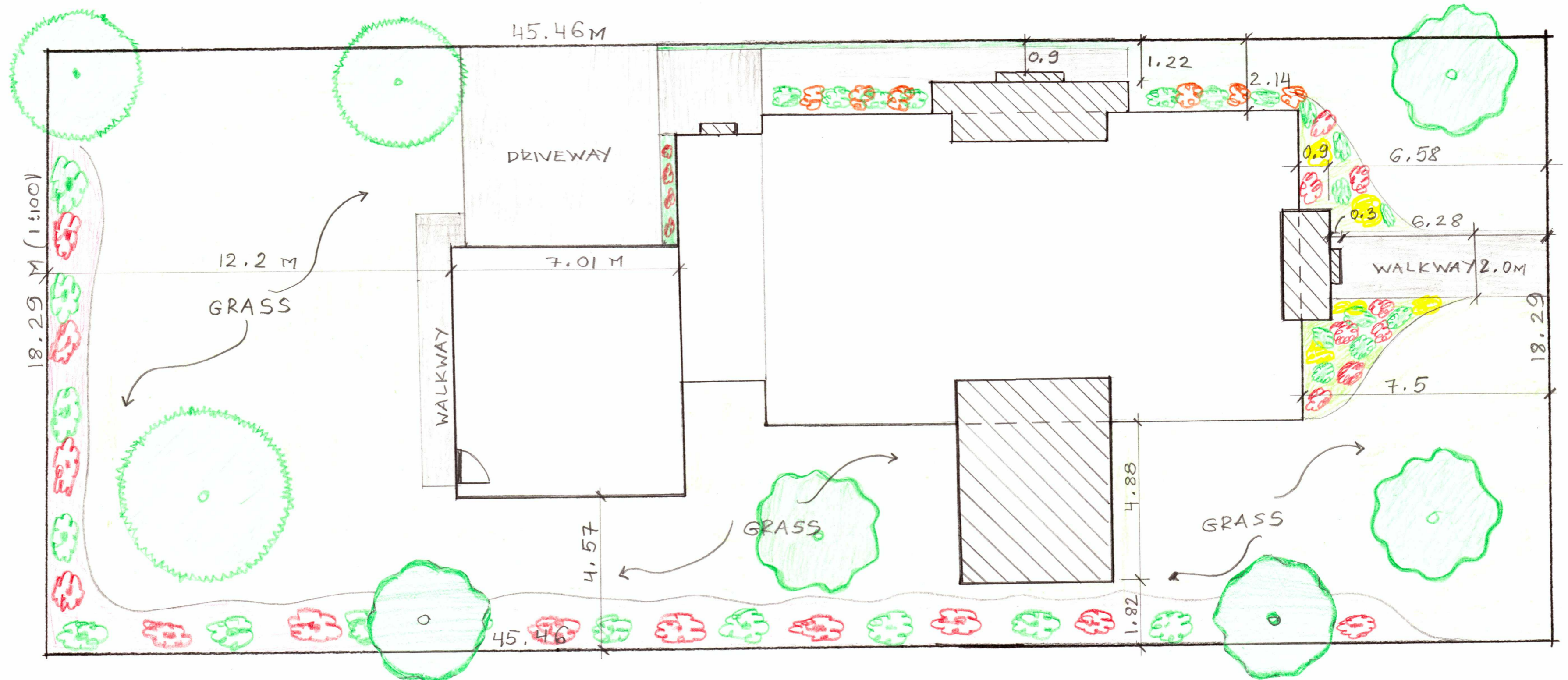

PROPOSED PRIVATE RESIDENCE
 407 VICTORIA STREET
 NOTL, ONTARIO
 PROPOSED LANDSCAPING
 MARCH 19, 2025.

LOT AREA: 831.14 M SQ	
TOTAL COVERAGE AREA:	
HOUSE:	159.70 M SQ
GARAGE:	53.34 M SQ
PORCH AND STEPS:	44.30 M SQ
WALKWAYS AND DRIVEWAY	76.10 M SQ
TOTAL:	333.44 M SQ
TOTAL LOT COVERAGE (%): 40.11 %	
LANDSCAPE OPEN SPACE (%): 59.88 %	

TREE TO BE PLANTED

EXISTING TREE