

GENERAL LEGEND:

- 
- LIGHT FIXTURE (CEILING MOUNTED)
- 
- LIGHT FIXTURE (WALL MOUNTED)

**RAIN WATER LEADER**  
LOCATION OF RAIN WATER LEADER TO TERMINATE AT SPLASH PAD IN STC OR STORM WATER DRAIN. RULE OF THUMB: DOWNSPOUT SIZING 1SQIN=100SQFT R.O.T.

**CONCRETE FOUNDATION WALL (20MPA)**  
-8" POURED CONCRETE FOUNDATION WALL  
-24" WIDE BY 8" DEEP  
FOOTING 4'-0" BELOW GRADE & RESTING ON UNDISTURBED SOIL.

**SIDING WALL WITH BRICK BASE**  
-BRICK VENEER AT BASE AND BOARD AND BATTEN ON THE UPPER PORTION  
-1" AIR SPACE FOR BASE VENEER  
-AIR BARRIER  
-1" (R5) RIGID BOARD  
-7/16" OSB WALL SHEATHING  
-2-2X6 SPF NO.1 OR 2 WOOD STUD @ 16" o/c  
W/ R19 BATT INSULATION  
-6 mil. VAPOUR BARRIER  
-1/2" GYPSUM BOARD

**SLAB ON GRADE**  
-5" THICK CONCR. SLAB (32 MPa) W/ 5-8% AIR ENTRAINMENT  
-2" (R10) RIGID INSULATION  
-6" GRAVEL BASE OF 3/4" CLEAR CRUSHED STONE  
-OPTIONAL 6"x6" x6/6" WMM REINFORCING WITHIN SLAB

**TRUSS ROOF**  
-ASPHALT SHINGLES  
-ICE & WATER SHIELD @ EAVES & VALLEY  
-FELT PAPER UNDERLAYMENT  
-5/8" T&G OSB SHEATHING  
-PRE-ENG TRUSSES  
-R60 BATT INSULATION  
-6 mil POLY VAPOUR BARRIER  
-1/2" GYPSUM BOARD

**STRUCTURAL LEGEND:**  
NAILING AS PER OBC REQUIREMENTS  
UNLESS NOTED OTHERWISE BY ENGINEER

**CLIMATIC DESIGN:**  
DESIGN SNOW LOAD 1.5kpa  
Hourly Wind Pressure 1/10: 0.33kpa  
Hourly Wind Pressure 1/50: 0.43kpa

**LINTELS**  
L1 2 - 2"x 8" SPF #2  
L2 2 - 2"x10" SPF #2  
L3 2 - 2"x12" SPF #2

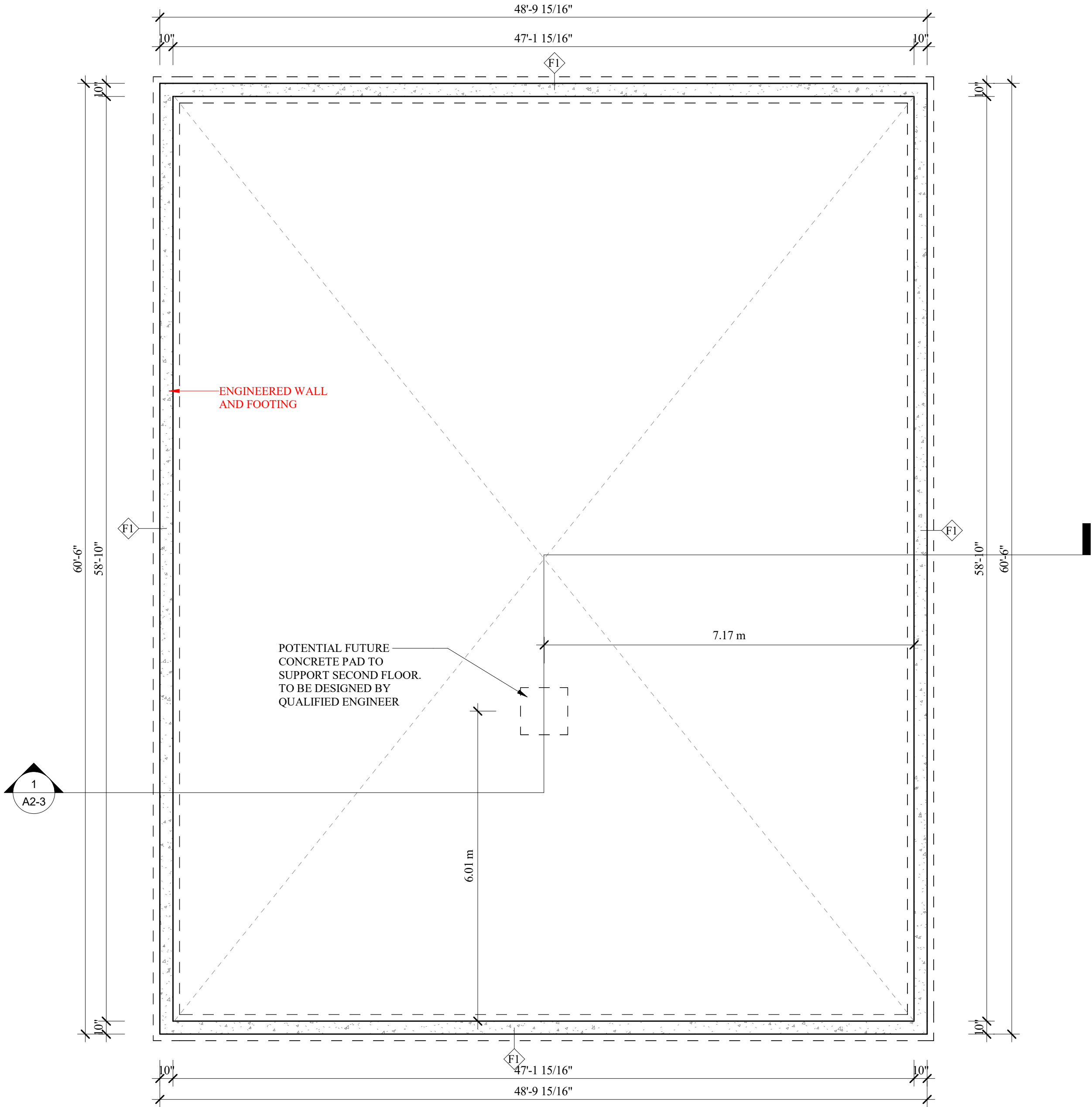

① FOUNDATION  
Scale: 3/16" = 1'-0"

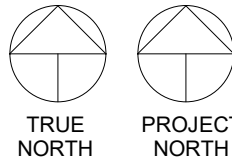

#	Description	Date
1	ISSUED FOR COORDINATION	27MAY2024
3	ISSUED FOR SEPTIC INSPECTION	08AUG2024
4	ISSUED FOR MINOR VARIANCE	17JAN2024

Do not scale drawings. Report any discrepancies to Jordan Station Design Co. Inc. before proceeding. Drawings must be signed by the Licensed Architectural Technologist prior to the use for any building permit applications and / or government approval. Drawings must be signed by the Technologist before drawings are used for any construction. All construction to be in accordance with the current Ontario Building Code & all applicable ON. regulations. All drawings & related documents remain the property of Jordan Station Design Co. Inc., All drawings are protected under copyright and under contract.



info@jordanstationdesignco.ca

The undersigned has reviewed and takes responsibility for this design, and has the qualifications and meets the requirements set out in the Ontario Building Code to be a designer.  
**QUALIFICATION INFORMATION**  
Required unless design is exempt under 3.2.5.1. of the Ontario Building Code

NAME	SIGNATURE	BCIN
------	-----------	------

**REGISTRATION INFORMATION**  
Required unless design is exempt under 3.2.4.1. of the Ontario Building Code

NAME	SIGNATURE	BCIN
------	-----------	------

## NEW ACCESSORY BUILDING

874 Line 1 Road,  
Niagara-on-the-Lake, ON, L0S 1J0

### FOUNDATION PLAN

Project number	23086
----------------	-------

Date	FEBRUARY 2025
------	---------------

Drawn by	GAC
----------	-----

Designed by	LC
-------------	----

A1-2

Scale	As indicated
-------	--------------

GENERAL LEGEND:

- LIGHT FIXTURE (CEILING MOUNTED)
- LIGHT FIXTURE (WALL MOUNTED)
- RAIN WATER LEADER**  
LOCATION OF RAIN WATER LEADER TO TERMINATE AT SPLASH PAD IN STC OR STORM WATER DRAIN. RULE OF THUMB: DOWNSPOUT SIZING 1SQIN=100SQFT R.O.T.

F1

**CONCRETE FOUNDATION WALL (20MPA)**  
-8" POURED CONCRETE FOUNDATION WALL  
-24" WIDE BY 8" DEEP  
FOOTING 4'-0" BELOW GRADE & RESTING ON UNDISTURBED SOIL.

W1

**SIDING WALL WITH BRICK BASE**  
-BRICK VENEER AT BASE AND BOARD AND BATTEN ON THE UPPER PORTION  
-1" AIR SPACE FOR BASE VENEER  
-AIR BARRIER  
-1" (R5) RIGID BOARD  
-7/16" OSB WALL SHEATHING  
-2-2X6 SPF NO.1 OR 2 WOOD STUD @ 16" o/c  
W/ R19 BATT INSULATION  
-6 mil. VAPOUR BARRIER  
-1/2" GYPSUM BOARD

F1

**SLAB ON GRADE**  
-5" THICK CONCR. SLAB (32 MPa) W/ 5-8% AIR ENTRAINMENT  
-2" (R10) RIGID INSULATION  
-6" GRAVEL BASE OF 3/4" CLEAR CRUSHED STONE  
-OPTIONAL 6"x6" x6/6" WMM REINFORCING WITHIN SLAB

R1

**TRUSS ROOF**  
-ASPHALT SHINGLES  
-ICE & WATER SHIELD @ EAVES & VALLEY  
-FELT PAPER UNDERLAYMENT  
-5/8" T&G OSB SHEATHING  
-PRE-ENG TRUSSES  
-R60 BATT INSULATION  
-6 mil POLY VAPOUR BARRIER  
-1/2" GYPSUM BOARD

**STRUCTURAL LEGEND:**  
NAILING AS PER OBC REQUIREMENTS  
UNLESS NOTED OTHERWISE BY ENGINEER

**CLIMATIC DESIGN:**  
DESIGN SNOW LOAD 1.5kpa  
Hourly Wind Pressure 1/10: 0.33kpa  
Hourly Wind Pressure 1/50: 0.43kpa

**LINTELS**  
L1 2 - 2"x 8" SPF #2  
L2 2 - 2"x10" SPF #2  
L3 2 - 2"x12" SPF #2

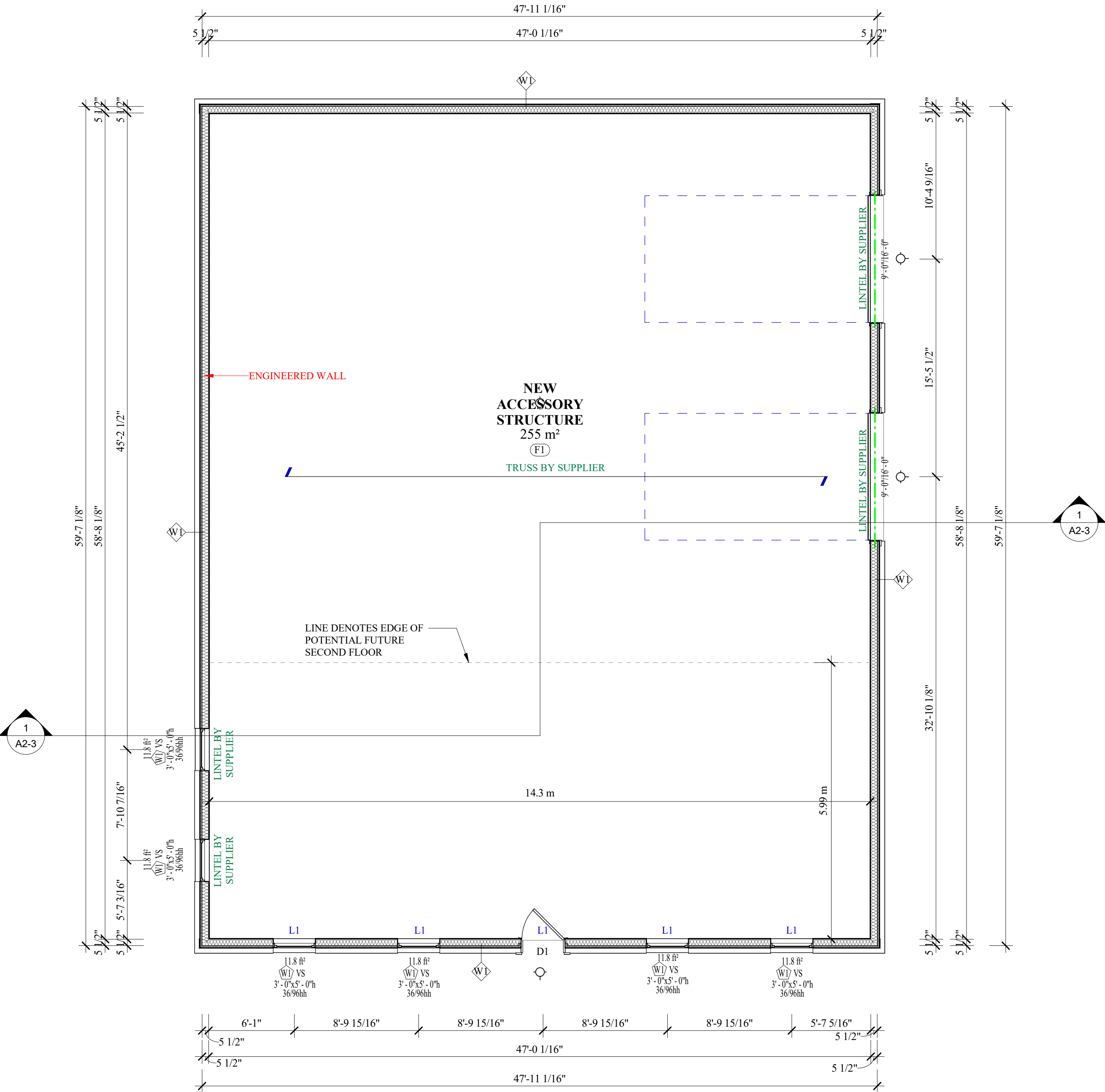

① GROUND FLOOR  
Scale: 3/16" = 1'-0"

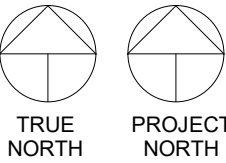

#	Description	Date
1	ISSUED FOR COORDINATION	27MAY2024
3	ISSUED FOR SEPTIC INSPECTION	08AUG2024
4	ISSUED FOR MINOR VARIANCE	17JAN2024

Do not scale drawings. Report any discrepancies to Jordan Station Design Co. Inc. before proceeding. Drawings must be signed by the Licensed Architectural Technologist prior to the use for any building permit applications and / or government approval. Drawings must be signed by the Technologist before drawings are used for any construction. All construction to be in accordance with the current Ontario Building Code & all applicable ON. regulations. All drawings & related documents remain the property of Jordan Station Design Co. Inc., All drawings are protected under copyright and under contract.



info@jordanstationdesignco.ca

The undersigned has reviewed and takes responsibility for this design, and has the qualifications and meets the requirements set out in the Ontario Building Code to be a designer.  
**QUALIFICATION INFORMATION**  
Required unless design is exempt under 3.2.5.1. of the Ontario Building Code

NAME	SIGNATURE	BCIN
<b>REGISTRATION INFORMATION</b> Required unless design is exempt under 3.2.4.1. of the Ontario Building Code		

NAME	SIGNATURE	BCIN
------	-----------	------

## NEW ACCESSORY BUILDING

874 Line 1 Road,  
Niagara-on-the-Lake, ON, L0S 1J0

### GROUND FLOOR PLAN

Project number	23086
Date	FEBRUARY 2025
Drawn by	GAC
Designed by	LC

A1-3

Scale	As indicated
-------	--------------